

Reference Only

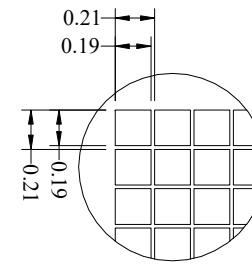

Scale (10:1)

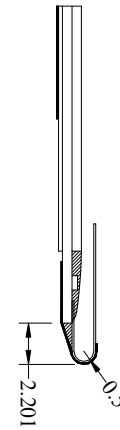
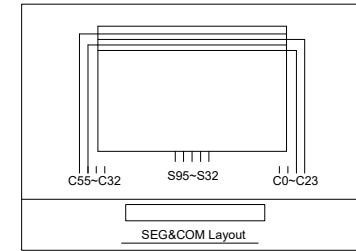

Pin	Symbol
1	N.C. (GND)
2	C2P
3	C2N
4	C1P
5	C1N
6	VBAT
7	VSS
8	VDD
9	BS1
10	BS2
11	CS#
12	RES#
13	D/C#
14	R/W#
15	E/RD#
16	D0
17	D1
18	D2
19	D3
20	D4
21	D5
22	D6
23	D7
24	IREF
25	VCOMH
26	VCC
27	VLSS
28	N.C. (GND)

NOTE:

- COLOR: WHITE
- OPERATING VOLTAGE: VDD=2.8V (TYP.)
- DRIVE DUTY: 1/48
- DRIVER IC: SSD1315
- OPERATING TEMP.: -40°C ~ 85°C
- STORAGE TEMP.: -40°C ~ 85°C
- INTERFACE: 8-BIT 6800/8080 PARALLEL, 4-WIRE SPI, I²C
- GENERAL TOLERANCE: ±0.3MM
- ROHS COMPLIANT

		MULTI-INNO TECHNOLOGY CO., LTD.	
		DRAWN BY: CAROL 2020.04.29	
CHECKED BY:	SCALE : 1/1	UNIT: mm	DESCRIPTION: OLED MODULE
VER. 01	FIRST ISSUE	CAROL 2020.04.29	APPROVED BY:
REVISOR	REVISED DESCRIPTION	REVISER	DATE
VERSION NO:	01	SHEET NO.: 1/1	

01	FIRST ISSUE	CAROL	2020.04.29
VER.	REVISED DESCRIPTION	REVISOR	DATE